

THE NATIONAL ACADEMIES

Advisers to the Nation on Science, Engineering, and Medicine

Space Studies Board

Mailing Address:
500 Fifth Street, NW
Washington, DC 20001
www.nationalacademies.org

2nd CAS-NAS Forum for New Leaders in Space Science

**Space Studies Board
National Research Council**

**National Space Science Center
Chinese Academy of Sciences**

PROGRAM

November 3-4, 2014

**Huntington Room
100 Academy Drive**

**Beckman Center
Irvine, California**

Monday, November 3

7:45 a.m.	Assemble in Main Lobby of Ayres Hotel for transport to Beckman Center	
8:00 a.m.	Breakfast	Beckman Center Refectory
8:55 a.m.	Welcome to the Beckman Center	Michael MOLONEY Space Studies Board
9:00 a.m.	Welcome to the Second Forum	David SPERGEL Princeton University
9:05 a.m.	Status of CAS Space Science Programs	Ji WU CAS National Space Science Center
9:30 a.m.	Two Epochs of Acceleration: Inflation and Dark Energy	David SPERGEL Princeton University
10:15 a.m.	Break	
10:45 a.m.	Fermi Bubbles: Unexpected Discovery and What We Can Learn for Future Space Missions	Meng SU MIT/CfA
11:30 a.m.	Special Guest Presentation	Fiona HARRISON California Institute of Technology

12:00 p.m.	Lunch	Beckman Center Refectory
1:30 p.m.	Space Low-Frequency VLBI Mission	Tao AN CAS Shanghai Astronomical Observatory
2:15 p.m.	Space and Ground Based Astronomical Characterization of Near Earth Asteroids	Michael W. BUSCH SETI Institute
3:00 p.m.	Break	
3:30 p.m.	Imaging Science Investigations of Saturn's Atmosphere from Cassini Orbiter	Kunio M. SAYANAGI Hampton University
4:15 p.m.	Asymmetries and Magnetic Fields in Supernovae and their Progenitors	J. Craig WHEELER University of Texas
5:00 p.m.	General Discussion	All Participants
5:45 p.m.	Assemble outside Beckman Center for transport to dinner	
6:00 p.m.	Dinner	Prego Ristorante 18420 Von Karman Avenue Irvine, CA 92612 949-553-1333
8:00 p.m.	Assemble outside Prego for transport back to Ayres Hotel	

Tuesday, November 4

7:45 a.m.	Assemble in Main Lobby of Ayres Hotel for transport to Beckman Center ¹	
8:00 a.m.	Breakfast	Beckman Center Refectory
8:55 a.m.	Introduction to day two	Chi WANG CAS National Space Science Center
9:00 a.m.	Solar Active Phenomena Observed with the New Vacuum Solar Telescope	Shu-Hong YANG CAS National Astronomical Observatories

¹ CAS participants departing on flight CA984 and SSB staff should check out of the Ayres Hotel prior to departure for Beckman Center. Take your luggage with you to the Beckman Center. A bag room is available at the Beckman Center.

9:45 a.m.	High Fidelity Multi-Fluid Modeling of Coronal Mass Ejections.	Vyacheslav LUKIN U.S. Naval Research Laboratory
10:30 a.m.	Break	
11:00 a.m.	Magnetic Non-potentiality in Solar Eruptions	Yingna SU CAS Purple Mountain Observatory
11:45 p.m.	Lunch	Beckman Center Refectory
12:45 p.m.	The 3-D CME: Lessons Learned, Confirmed, And Unearned!	R.T.James McATEER New Mexico State University
1:30 p.m.	Anomalous C^{6+}/C^{5+} Ratio in Slow Solar Wind Associated with Active Regions	Liang ZHAO University of Michigan
2:15 p.m.	Global MHD Modeling of the Solar Wind-Magnetosphere-Ionosphere System	Chi WANG CAS National Space Science Center
3:00 p.m.	Break	
3:15 p.m.	New Ways to Observe the Inner Heliosphere With Next-Generation, Low-Frequency Radio Arrays	Justin C. KASPER University of Michigan
4:00 p.m.	A Novel Technique for Constructing the Global Chorus Wave Intensity Using Low-Altitude NOAA POES Electron Data and its Application for Radiation Belt Research	Binbin NI Wuhan University
4:45 p.m.	Behavior of Plasma in Cusp-Like Regions of Mars's Magnetic Field	Paul WITHERS Boston University
5:30 p.m.	Final Thoughts	Charles KENNEL University of California, San Diego
6:00 p.m.	Farewell Barbecue	Beckman Center Dining Terrace
8:00 p.m.	Adjourn	
8:10 p.m.	Bus to LAX departs from Beckman Center	

NOTES

Beckman Center: Is located on the campus of the University of California, Irvine, and is approximately 3 miles from Orange County/John Wayne Airport. See the following website for more information, including directions: <http://www7.nationalacademies.org/beckman/>

Hotel: A block of rooms has been reserved for the forum's use at the Ayres Hotel and Suites (a.k.a. the Country Inn, or Ayres Country Inn, or one of several other permutations of "Ayres," "Country Inn," "Hotel," and "Suites"), 325 Bristol St., Costa Mesa, CA 92626 (714-549-0300, 800-322-9992, 714-662-0828(fax)). Additional information, including directions can be found at the following website: <http://www.ayreshotels.com/costamesa/>. This hotel is located adjacent to John Wayne/Orange Country Airport and is about 3 miles from the Beckman Center.

CAS Group 1 Arrival at LAX on Sunday morning: Those arriving from Beijing on CA987 at about 10:30 a.m. on Sunday, 2 November, will be met at the airport by DHS² and then directed to a bus to take you to the Ayres Hotel. If you don't see me, get separated from the rest of the group, or have some other mishap send a text message to DHS² at +1-571-830-0429. If your plane is on time, you don't get stuck in immigration or customs and there are no holdups on the freeway to Costa Mesa, expect to check-in at the Ayres Hotel at about 1:00 p.m. If you get stranded at LAX and cannot reach DHS² take a taxi to the Ayres Hotel.

CAS Group 2 Arriving at LAX on Sunday Evening: Those arriving from Chicago and Boston on UA1251 and UA717, respectively, at about 10:40 p.m. on Sunday, 2 November, will be met at the airport by DHS² and he will drive you to the Ayres Hotel in his car. If you don't see DHS or have some other mishap send a text message to him at +1-571-830-0429. If your plane is on time, and there are no holdups on the freeway to Costa Mesa, expect to check-in at the Ayres Hotel at about 11:00 p.m. If you get stranded at LAX and cannot reach DHS² take a taxi to the Ayres Hotel.

Sunday Afternoon Excursions: There will be limited (and informal opportunities) for exploring the local area (e.g., Newport Beach or Laguna Beach) and/or shopping (e.g., in Fashion Island or the South Coast Plaza) on Sunday afternoon. We are meeting in the capital of "car culture;" you cannot really get anywhere very far on foot. Those interested in venturing out from the immediate vicinity of the hotel should rendezvous in the main lobby of the Ayres Hotel at 3:00 p.m. The extent of the excursions will depend on the number of cars available and so the assistance of those U.S. participants with cars is greatly appreciated. The Ayres Hotel's shuttle bus that can provide some limited local transport.

Sunday Dinner: No formal arrangements have been made for a group dinner on Sunday November 2, so you are on your own. The restaurant at the Ayres Hotel is quite good and there are several other cheap options within easy walking distance on the north and south sides of Bristol St (go out of the hotel and turn left). Restaurants in or near the Ayres Hotel include the following:

² David H. SMITH

Le Chateau Restaurant (inside the Ayres Hotel)

325 Bristol St Costa Mesa, CA 92626

(714) 549-0300

Cuisine: American, French

Recommendation: I have eaten here many times and have found it to be pretty good—DHS

Bill's Burgers

1476 Bristol St Costa Mesa, CA 92626

(714) 437-9676

Cuisine: American

Recommendation: This is your basic Southern California burger joint. Don't go here if you want fine dining. I have eaten here a couple of times (once with an NRC committee) and have found it to be quite reasonable—DHS

Flame Broiler

320 Bristol St Costa Mesa, CA 92626

(714) 850-1140

Cuisine: Korean

Rating: 3.7 out of 5 stars

Inka Grill

260 Bristol St Costa Mesa, CA 92626

(714) 444-4652

Cuisine: Peruvian

Recommendation: I have been here on my own and with others on several occasions and have found it to be good. Go here if you are very hungry—DHS

Sweet Basil Pizzeria and Cafe

270 Bristol St Unit 114 Costa Mesa, CA 92626

(714) 241-1444

Cuisine: Italian

Rating: 4.3 out of 5 stars

Wafu of Japan Sushi

320 Bristol St Costa Mesa, CA 92626

(714) 641-7321

Cuisine: Japanese

Rating: 4.8 out of 5 stars

Monday/Tuesday Breakfast and Lunch: Available to all Forum participants in the refectory at the Beckman Center.

Monday Dinner: All participants in the Forum are invited to dinner on Monday November 3 at Prego Ristorante, 18420 Von Karman Avenue, Irvine, CA 92612 (Tel. 949-553-1333). More information about Prego can be found at: <http://www.pregoristoranti.com/>.

Tuesday Dinner: All participants in the Forum are invited to attend the farewell barbecue on the Beckman Center's Dinning Terrace on Tuesday November 4.

Return Bus to LAX: Those CAS participants planning to return to Beijing on CA984 departing from LAX at 00:40 a.m. on November 5 should check out of the Ayres Hotel on Tuesday November 4 prior to departing for the Beckman Center. You can leave your luggage in the baggage room at the Beckman Center. The bus to LAX will depart from the Beckman Center at 8:10 p.m.

Parking: There is plenty of free parking at the Beckman Center and at the Ayres Hotel. There is only valet parking at Prego.

Airports: Orange County/John Wayne Airport (SNA) is about 2 miles from both the Beckman Center and 1 mile from the Ayres Hotel. Los Angeles International Airport (LAX) is about 40 miles from the meeting site. Long Beach Airport (LGB) is about 26 miles distant.

Beckman Center Floor Plan

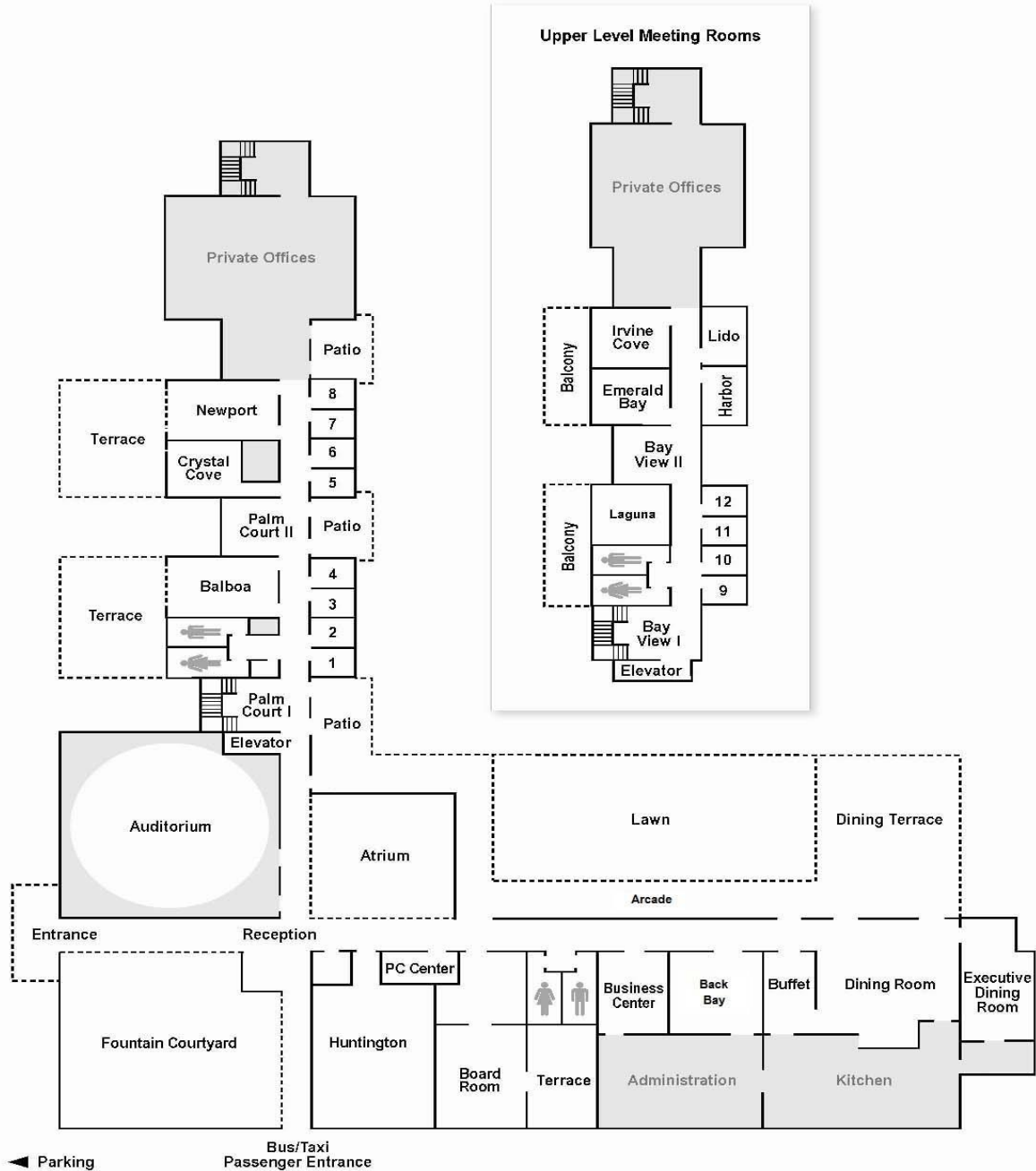

Meeting Map

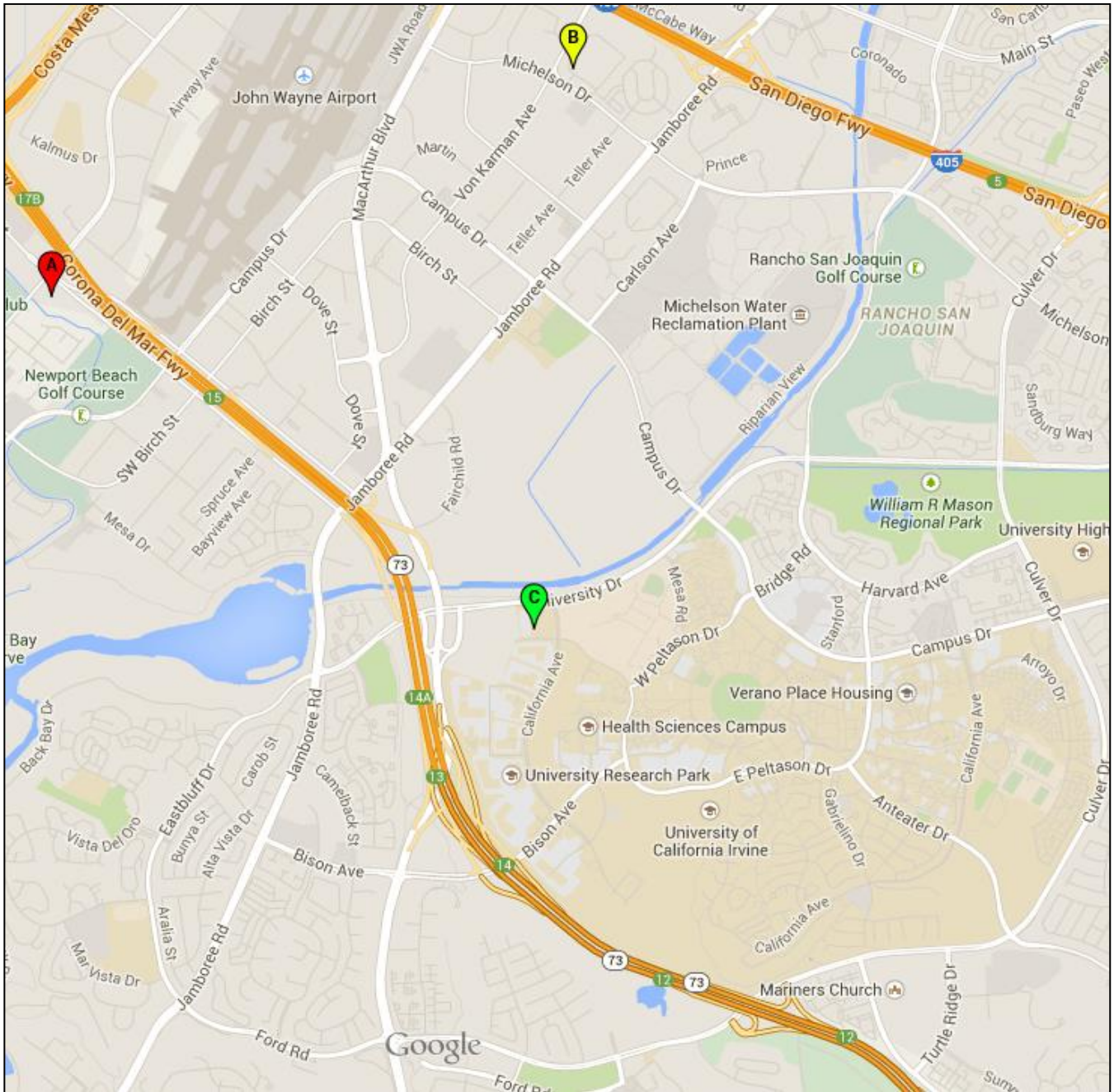

-  **Ayres Hotel & Suites Costa Mesa / Newport Beach**
-  **Prego Ristorante**
-  **Beckman Center of the National Academies of Sciences & Engineering**

Ayres Hotel to the Beckman Center

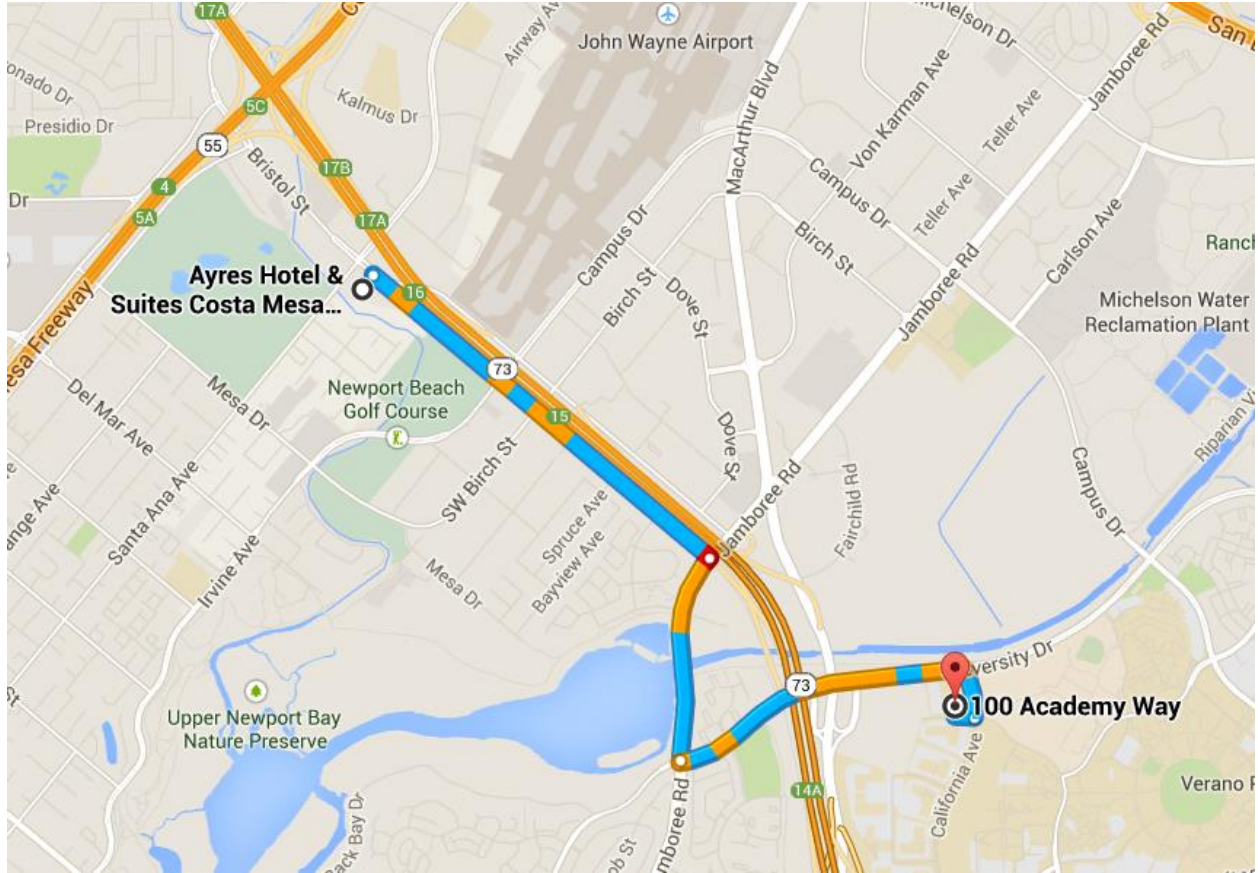

Head southeast on Bristol St 1.2 mi
Turn right onto Jamboree Rd 0.6 mi
Turn left onto University Dr 0.8 mi
Turn right onto California Ave 0.1 mi
Take the 1st right onto Academy Dr 272 ft
Beckman will be on the right

Beckman Center to Prego Ristorante

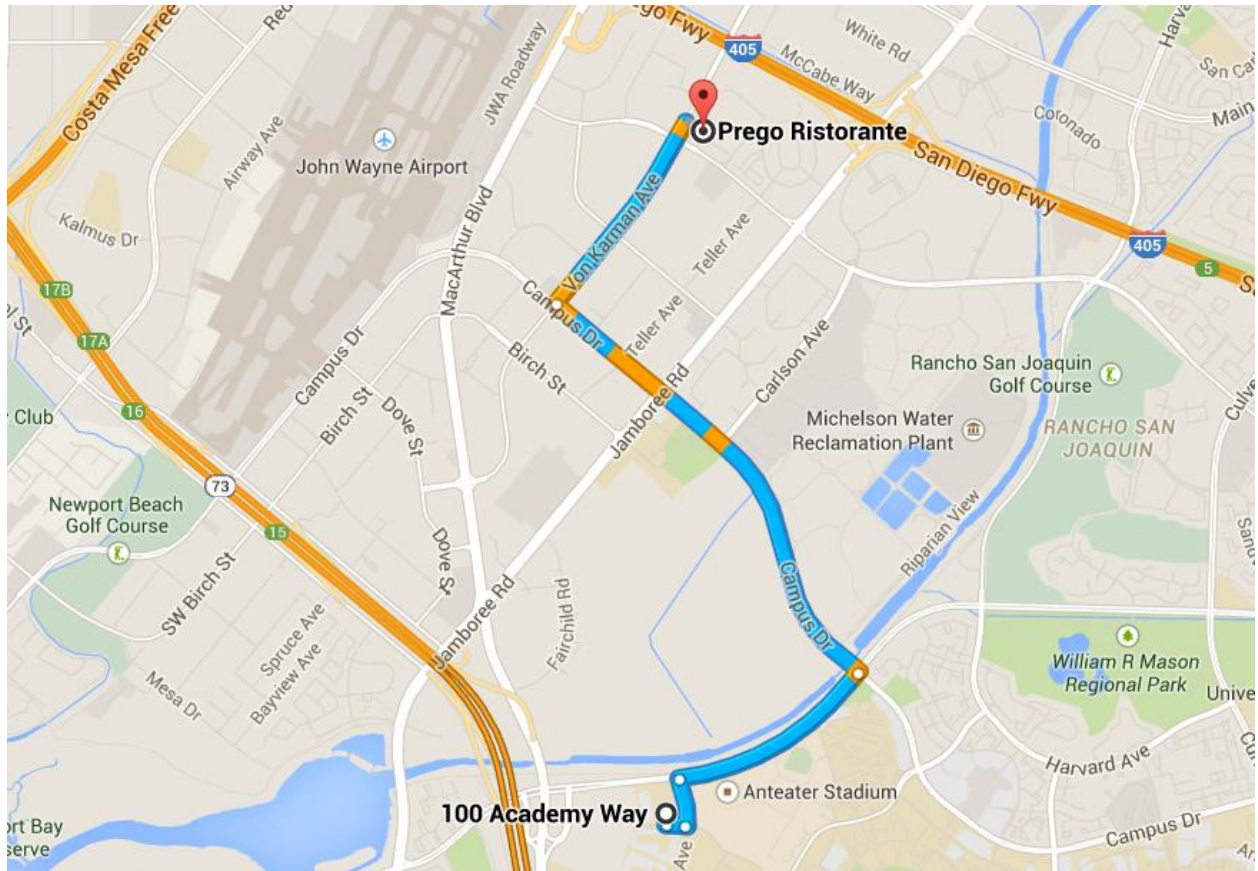

Head east on Academy Dr toward California Ave 272 ft
Turn left onto California Ave 0.1 mi
Turn right onto University Dr 0.6 mi
Turn left onto Campus Dr 1.4 mi
Turn right onto Von Karman Ave 0.6 mi
Prego will be on the right

Prego Ristorante to Ayres Hotel

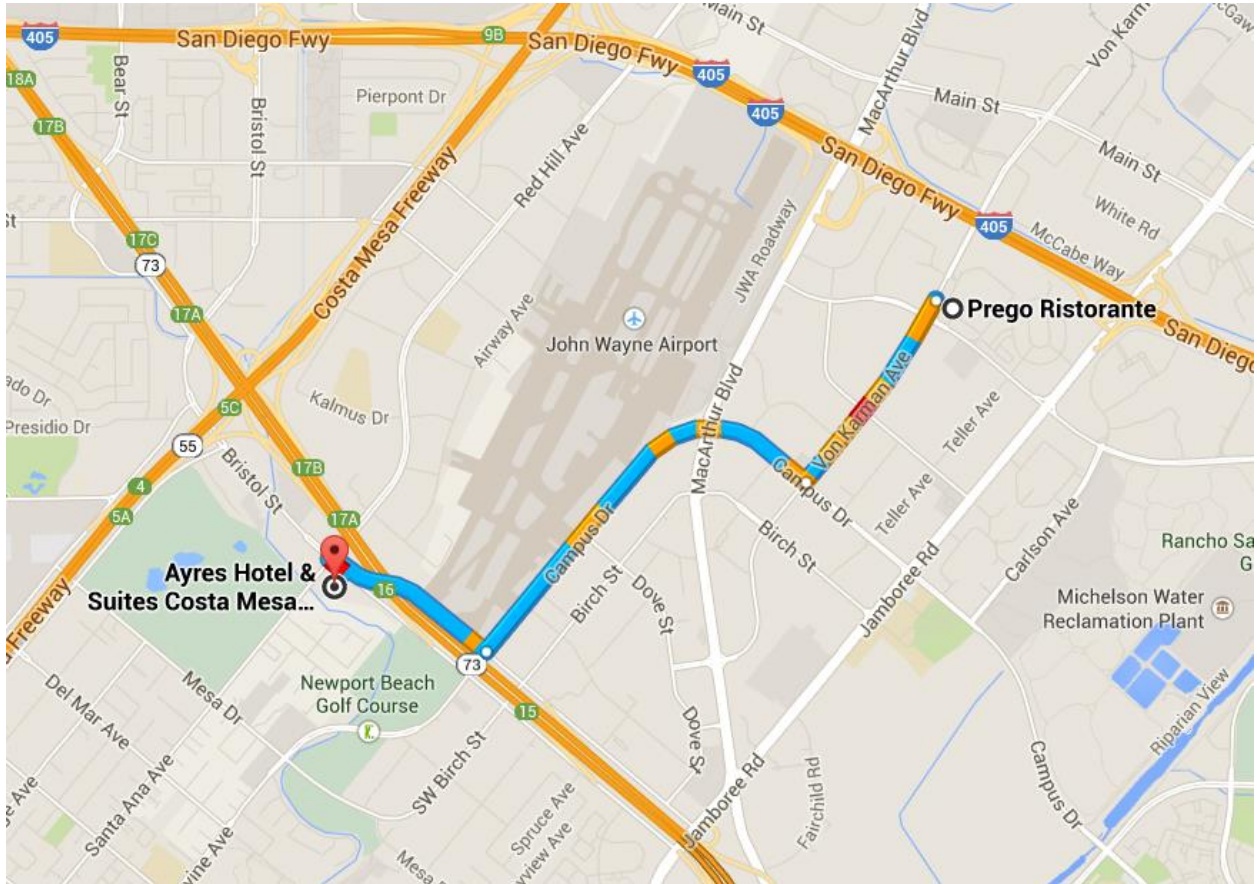

Head southwest on Von Karman Ave toward Michelson Dr 0.6 mi
Turn right onto Campus Dr 1.2 mi
Turn right onto Bristol St N 0.5 mi
Make a U-turn at Red Hill Ave 413 ft
Ayres Hotel will be on the right

Beckman Center to Ayres Hotel

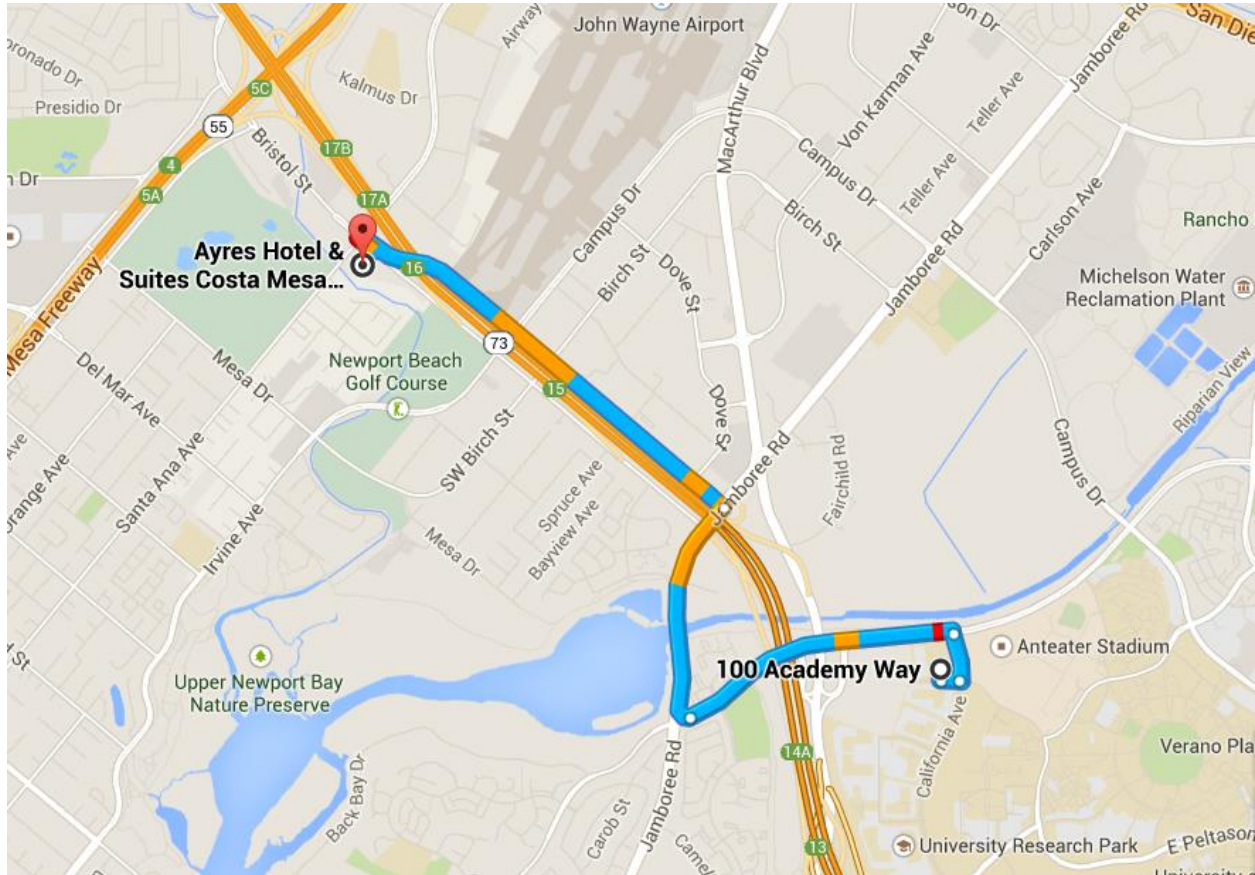

Head east on Academy Dr toward California Ave 272 ft
Turn left onto California Ave 0.1 mi
Take the 1st left onto University Dr 0.8 mi
Turn right onto Jamboree Rd 0.6 mi
Turn left onto Bristol St N 1.3 mi
Make a U-turn at Red Hill Ave 413 ft
Ayres Hotel will be on the right