

Tuesday, November 19 to Wednesday, November 20, 2019
 University of Washington, Husky Union Building
 4001 East Stevens Way N.E., Seattle, WA 98195

ACCESSIBILITY AND RESOURCE GUIDE

Table of Contents	Page
I. Commitment to an accessible, inclusive, and respectful meeting	1
II. Accessibility / Resource Spaces.....	2
III. Physical Accessibility	2-3
IV. Audio-visual Accessibility.....	3
V. Additional Considerations	3
VI. Maps.....	4-6

Commitment to an accessible, inclusive, and respectful meeting

Diversity of voices, social inclusion, and respect are at the heart of what we do in the *Action Collaborative on Preventing Sexual Harassment in Higher Education*, and we regard diversity of perspectives as a source of strength and richness to our work. We are committed to identifying, preventing, and removing barriers to participation at our Annual Public Summit. We aim to make the Summit a welcoming, inclusive event, and are continually working to improve the experience of our attendees; to provide feedback and make suggestions, we encourage you to [reach out to us at SHActionCollab@nas.edu](mailto:reach_out_to_us_at_SHActionCollab@nas.edu). As an attendee, we ask that you:

- Aim to understand and learn from each other
- Work to not interrupt those who are speaking
- Spirited discussions are expected on these topics – see this as a sign that folks are engaged and care, and remember to be respectful as you speak and listen
- Avoid assumptions or generalizations about groups. Do not ask individuals to speak for their (perceived) group.
- Commit to using a microphone when you ask questions, so that everyone can hear
- Be aware of attendees using canes or wheelchairs and give them room to get around
- Give up an easily accessible seat if someone needs it

The National Academies of Sciences, Engineering, and Medicine (NASEM) are committed to the principles of diversity, integrity, civility and respect in all our activities. We look to you to be a partner in this commitment by helping us to maintain a professional and cordial environment. More information about expectations for participants in NASEM activities can be found on our website (http://www.nationalacademies.org/about/NA_186023.html).

Accessibility/Resource Spaces:

Baby Changing Stations: Baby Changing Stations are installed in the men's and women's bathrooms on the First and Ground Floors, as well as in the gender neutral bathroom on the Third Floor.

Foot Washing Station: The HUB has 2 foot washing stations, one in each of the men's and women's bathrooms on the HUB Basement floor.

Gender-Neutral Restroom: The HUB has a gender neutral, family-friendly, and disability accessible bathroom on the HUB Third Floor. All HUB bathrooms are ADA compliant.

Lactation Station: Care givers are welcome to utilize the dedicated space and lactation services provided in the [Commuter & Transfer Commons](#) (HUB 141). The space is available on a first come, first served basis during Commuter & Transfer Commons operating hours (Monday-Thursday 8am-6pm). For access outside of operating hours, please contact the [HUB Information Desk](#).

Lost and Found: The central Lost and Found for the entire UW campus is housed in the HUB. If you have lost an item during or following the Summit, please visit [the Lost and Found website](#).

Office of the Ombud: The [UW Office of the Ombud](#) can be found on the third floor of the HUB, and is open 8am – 5pm Monday to Friday.

Support Space: Room HUB 339B (inside the Ombud Office) on the 3rd floor has been designated as a Support Space for individuals seeking assistance related to sexual harassment and other topics discussed at the Summit. A trained professional advocate will be available to listen, provide information, support and help in finding resources. You can also meet with the advocate if you are seeking advice on how to help a friend or colleague who has experienced harassment. The room is also available as a place to take a break and engage in self-care. The Support Space will be confidential. The only records kept will be how often the space is used, so that we can plan for providing this service at future Summits. The Support Space will be available 8:00 am – 5:30 pm on Tuesday (11/19) and 8:30 am – 12:30 pm on Wednesday (11/20).

Physical accessibility

Terrain: The UW Seattle campus is deceptively steep, rising from Lake Washington on the east to an elevation of 224 feet at the northwest corner, a rise equal to an 18-story building. Spanning approximately 15 blocks north to south and 25 blocks east to west, the University encourages wheelchair users to consider using power-operated wheelchairs on campus. Since the University is located on a sloping site, many of the pedestrian pathways have conditions that do not meet accessibility requirements for slope, duration, surface and rails. Individuals may need to experience a given route to determine if it is accessible for them. Please visit [the University of Washington's Access Guide](#) for more information.

Handicap accessible parking: Accessible parking permits for an accessible lot adjacent to the HUB (Lot N22), are available for visitors. If you would like to obtain an accessible parking permit, please reserve time to stop at [a gatehouse](#) prior to the event. For more information, visit [the UW Transportation website](#).

Other: If you need assistance with physically navigating the meeting, please notify a National Academies staff member or member of the UW volunteer group. This includes, but isn't limited to:

- Identifying a wheelchair-accessible space within the South Ballroom or breakout rooms
- A staff/volunteer guide to assist with navigating the poster session and/or lunch buffet

Campus Accessibility

Gatehouses

- Gatehouse

Entrances

- Assisted Entrance
- Multilevel Entrances
- Manual Entrance

Elevators

- Elevator

Parking

- Pay At Gatehouse
- Pay at Machine

Routes

- Navigable by Wheelchair
- Route without Stairs
- Underpass

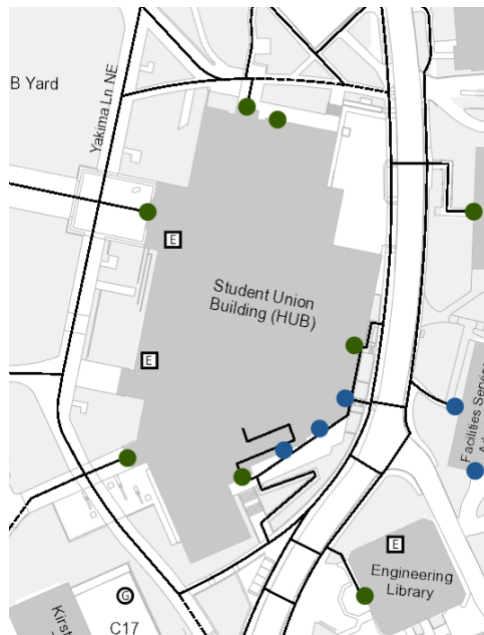

Audio-visual accessibility

Audio-visual capabilities: Each room has been equipped with the proper AV equipment to permit the use of microphones for all participants. All speakers and participants asking questions must use microphones. The South Ballroom has an Assisted Listening System; if you would like to reserve a device to utilize this system, feel free to reach out to [the HUB Main Desk](#) prior to the meeting or upon your arrival. English sign language interpretation and closed captioning will be available at the Summit.

Other: If you need assistance with communication-related for the meeting, please notify a NASEM staff member or member of the UW volunteer group. This includes, but isn't limited to:

- Assistance identifying a seat at the front of a room
- Digital materials for use with screen readers (blind and low-vision attendees) or printed materials (ADHD or learning disability attendees)

Additional considerations:

Dietary considerations: We seek to accommodate the dietary restrictions of all Summit attendees. Accordingly, attendees have been asked to indicate their dietary restrictions (vegetarian, vegan, dairy- or gluten-free, or otherwise) when they register to attend the Summit. Additional food options will be available in the [Husky Den Food Court](#).

Service animals: Members of the general public and their service animals may generally go wherever access to the public is granted. A service animal is an animal trained to perform tasks for an individual with a disability, including physical, sensory, mental, psychological, intellectual, or other mental disabilities. Service animals do not always have a harness, sign, or symbol indicating that they are service animals. Washington State defines a service animal as a dog or in some cases a miniature horse. Please visit [the University of Washington's service animals policy website](#) for more information.

MAPS

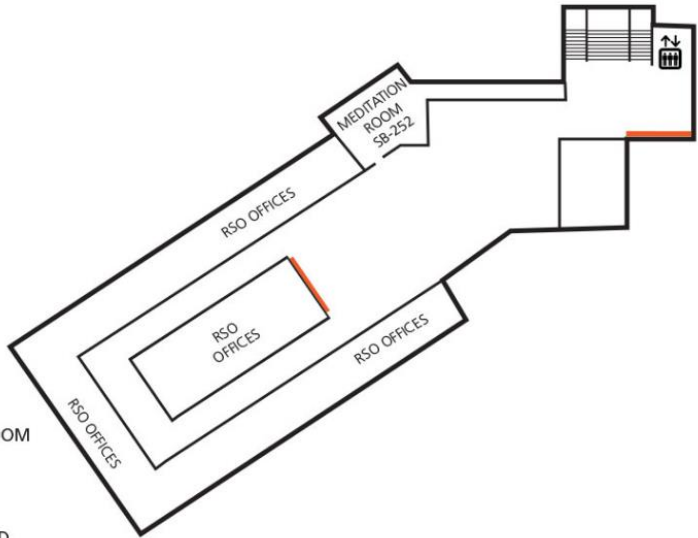

SB252 MEDITATION ROOM
SB253- RSO OFFICES
SB289
BULLETIN BOARD

SUB BASEMENT



B130-1 VIDEO GAME ARCADE
B150 GAMES COUNTER
B152 PARTY ROOM

BASEMENT

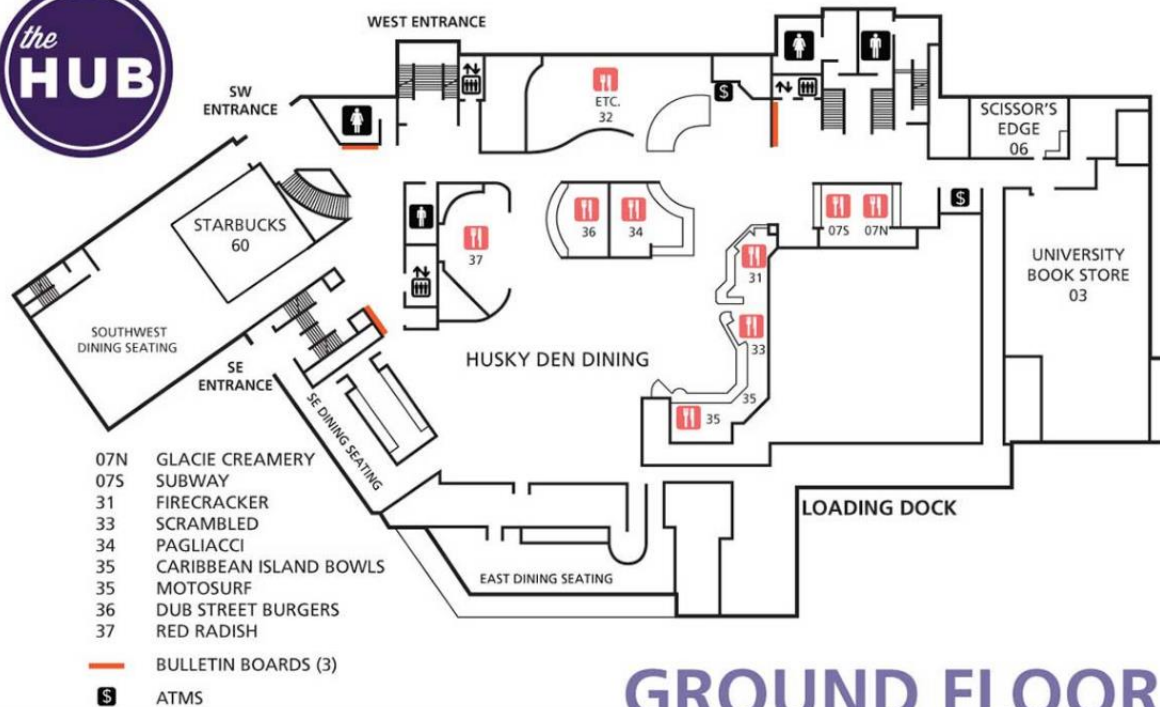

GROUND FLOOR

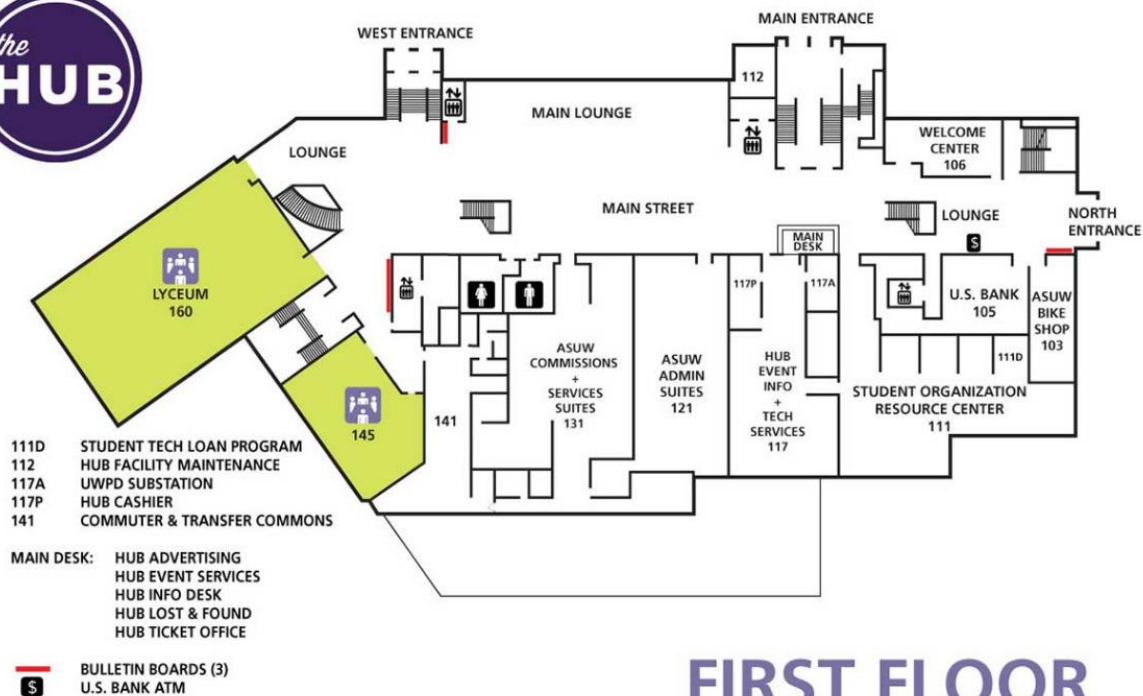

FIRST FLOOR

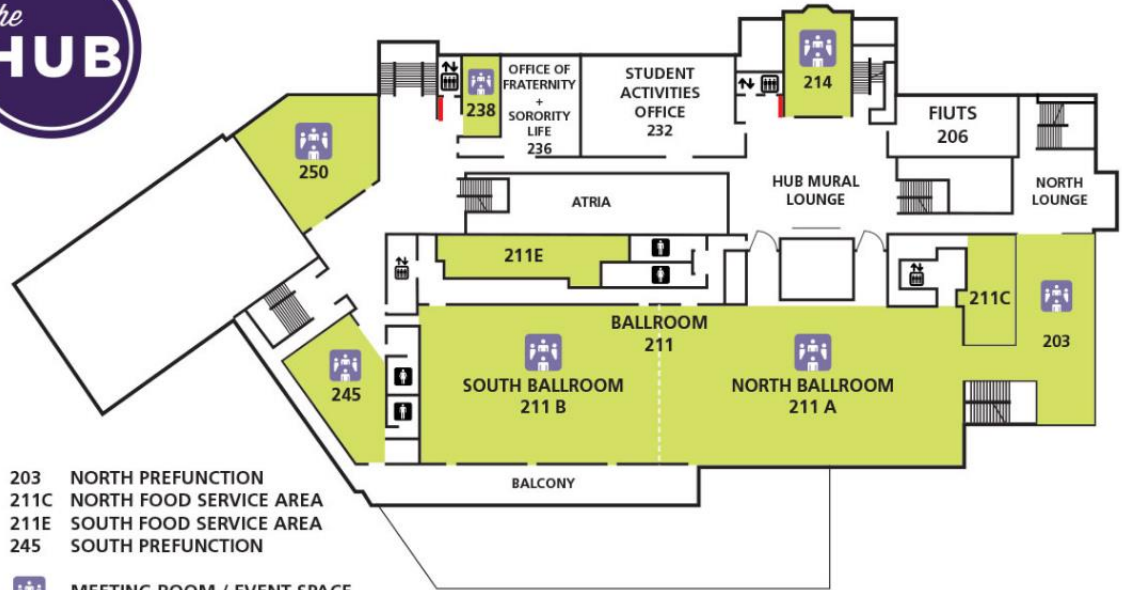

SECOND FLOOR

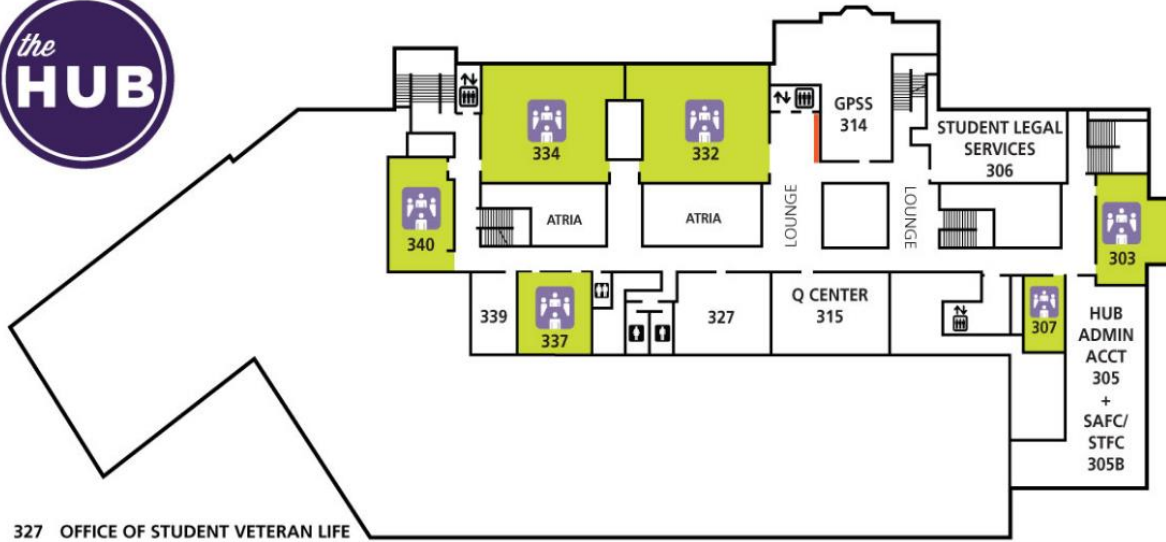

THIRD FLOOR