

The National Academies of
SCIENCES • ENGINEERING • MEDICINE

DIVISION ON ENGINEERING AND PHYSICAL SCIENCES
SPACE STUDIES BOARD
AERONAUTICS AND SPACE ENGINEERING BOARD

**FALL 2015 MEETING OF THE COMMITTEE ON BIOLOGICAL AND PHYSICAL SCIENCES IN
SPACE**

(subject to change)

October 27-29, 2015

Beckman Center – 100 Academy Drive – Irvine, CA

Tuesday, October 27, 2015

Newport Room

OPEN SESSION

Remote Access

WebEx: <http://tinyurl.com/pg2z8qa> WebEx Meeting Password: 1027

Dial In: 1-(866) 668-0721 Telecon Conference Code: 797 795 6056

10:30 AM	Program Status and Issues <ul style="list-style-type: none">• SLPSRA research plans overview• Integrating space biology and human research• Challenges and opportunities• Other issues to share with committee• Manifesting challenges	Marshall Porterfield, NASA SLPSRA
10:55 AM	Genelab and Open Science Status and Planning	Marshall Porterfield, NASA SLPSRA
11:15 AM	Space Biology Planning - Status, planning, research findings, challenges	David Tomko, NASA
12:15 PM	<i>Lunch available in the Beckman Center Refectory, committee discussion will continue</i>	
1:15 PM	Human Research Planning - Status, planning, research findings, challenges	Steve Davison, NASA
2:45 PM	<i>Break</i>	
2:55 PM	Physical Sciences - Status, planning, research findings, challenges - Update on MaterialsLab	Francis Chiramonte, NASA (webex)
3:55 PM	Fundamental Physics Planning - Status, planning, research findings, challenges	Nan Yu, JPL

- 4:45 PM** **General Discussion**
 - Near term concerns and needs
 - Far term directions
 - Microgravity research beyond ISS

5:30 PM *Adjourn*

Wednesday, October 28, 2015

Newport Room

OPEN SESSION

Remote Access

WebEx: <http://tinyurl.com/owmsgs9> WebEx Meeting Password: 1028
 Dial In: 1-(866) 668-0721 Telecon Conference Code: 797 795 6056

- 8:00 AM** Meeting Room Opens
(Breakfast available in the Beckman Center Refectory)
- 9:00 AM** **NASA and Commercial LEO for research** **Robyn Gatens, NASA (via WebEx)**
- 9:45 AM** **Promoting LEO Ecosystem development** **Warren Bates, CASIS (telecon)**
- 10:30 AM** *Break*
- 10:40 AM** **Discussion on Commercial LEO/ISS follow-on issues** **Ben Roberts/OSTP (telecon)**
- 11:15 AM** **View from Capitol Hill** **Tom Hammond, Pam Whitney TBC, HCSST**
- 11:30 AM** **Discussion**
- 12:00 PM** *Lunch available in the Beckman Center Refectory,
 committee discussion will continue*
- 1:00 PM** **Panel Session: Potential of CubeSats for Microgravity Research**
- Moderator: Rob Ferl**
- Introduction:** Thomas Zurbuchen, U. Michigan
- Keynote presentation:** *(30 minutes)*
- Tony Ricco, NASA
 - Wayne Nicholson, University of Florida
- Virtual Panel Discussion:** *(3-5 minutes each)*
- A.C. Matin, Stanford
 - John Hines, JH Technology Associates
 - Sharmila Bhattacharya, NASA Ames *invited*
 - Andrew Pohorille, NASA
- Moderated Discussion** *(30 minutes)*
- Audience Joins the Discussion** *(30-40 minutes)*

3:00 PM *Break*

3:10 AM **Biological experiments on the Orion EM-1 Mission**

Jeff Smith, NASA

Webex ends

3:50 PM **Breakout groups**

Guests and Committee

- Microgravity future/organization issues
- GeneLab technical discussion
- SLPSRA needs and concerns

5:30 PM *Adjourn*

Thursday October 29, 2015

CLOSED SESSION

GENERAL NOTES

Beckman Center: Is located on the campus of the University of California, Irvine, and is approximately 3 miles from Orange County/John Wayne Airport. See the following website for more information, including directions: <http://www.thebeckmancenter.org/>

Breakout Rooms: The following breakout rooms are available for the committee's use on Wednesday, October 28th: Balboa Room (1st floor) and Emerald Bay (2nd floor).

Parking: There is plenty of free parking at the Beckman Center.

Beckman Center Floor Plan

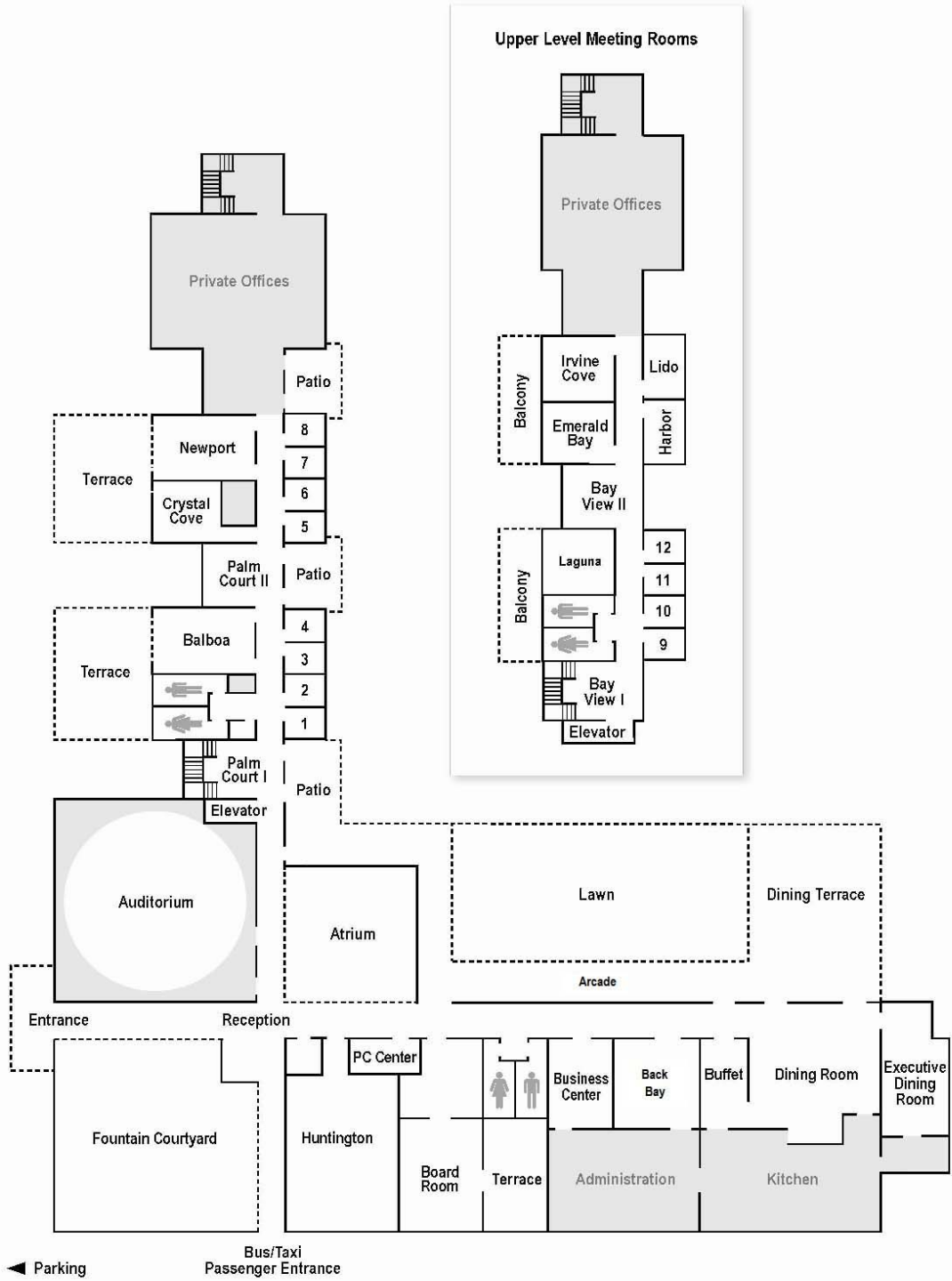

ese